

Rutherglen High School



Student Handbook 2024



Page 1	Cover Page
Page 2	Table of Contents
Page 3 - 4	Rutherglen High School Overview
Page 5	Staff ‘Who’s who?’
Page 6	Location of Rutherglen High School
Page 7	Rutherglen High School Map of Rooms
Page 8	Daily Organisation including Bell Times
Page 9	Transition Program
Page 10	Subjects Offered at Year 7
Page 11 – 12	Year 7 at Rutherglen High School
Page 13	Code of Co-operation
Page 14	Rules that flow from Code of Co-operation
Page 15	Statement of Commitment to Child Safety
Page 16	What do you do if.....
Page 17	Personal Safety and Welfare Issues
Page 18 - 19	Bullying or Harassment are <i>not on</i> at RHS
Page 20 - 23	School Dress Code
Page 24 - 25	General Information
Page 26	Extra-curricular Activities
Page 27 – 28	What’s GREAT about Rutherglen High School

Rutherglen High School Overview

Rutherglen High School (enrolment 307) is situated in North-East Victoria servicing the rural townships of Chiltern, Rutherglen, Springhurst, Wahgunyah and the surrounding farming communities. The school provides a challenging and comprehensive curriculum with the flexibility to meet the needs of each student. All students are able to participate in an environment that values and respects their achievements. Students are expected to display a commitment to improve their skills and knowledge, develop self-discipline and initiative and respect themselves, each other and their environment. They are also expected to develop positive relationships with their peers and teachers and take responsibility for themselves and their education.

Students in Years 7 and 8 study a core curriculum based on the Victorian Curriculum. This involves sequential courses of study in English, Languages Other Than English (French), Mathematics, Health and Physical Education, Science and Humanities. They also complete a semester of eight different Art & Technology subjects over the course of these two years in order for them to make an informed decision about their subject selections in Year 9 and beyond. The Art & Technology subjects include: 2 Dimensional Drawing, 3 Dimensional Drawing, Visual Communication & Design, Music, Woodwork, Metalwork, Textiles, Food Technology and Performance.

The Year 9 Program includes discipline based subjects (English, Maths, Humanities, Science) as well as interdisciplinary studies involving initiative, independence and community involvement. Subjects such as 'Future Makers' and 'Farm to Table' are offered as well as a wide range of Art and Technology electives which allow students to investigate these subjects further.

Year 10 has a 'Core' plus elective program that allows students to pursue their interests and career aspirations. Students are able to access VCE/VET Units whilst in Year 10 and there is an option of selecting a Vocational Program ('Applied Learning') which incorporates Work Placement in conjunction with their school based subjects. In Year 11 and 12, students can choose from an extensive range of Victorian Certificate of Education (VCE) studies, Vocational Education and Training (VET) programs and Victorian Certificate of Applied Learning (VCAL) units.

The school boasts a qualified, dedicated teaching staff committed to securing the best possible learning outcomes for all students. The school takes every opportunity to broaden students' experiences. It provides a wide range of extra-curricular and enrichment programs including: excursions, interschool sports, debating, public speaking, a Cattle Program, annual musical production, instrumental music, VCE workshops and lunchtime activities. The school also operates a Year 7 Orientation Camp, Year 9 Bogong/Future Makers Camp, Year 10 Urban Experience, Leadership Camps and a Year 12 Study Skills Camp. These activities foster the qualities of: leadership, initiative, independence, self-confidence, self-esteem, problem solving, decision-making, resilience, teamwork and social skills.

The school is located on approximately 13 hectares of land and provides an attractive and stimulating environment for student and community use. There are excellent outdoor sporting facilities on site including the Rutherglen Community Centre. Members of the community can also enjoy a meal in "The Vine" which is the school's own restaurant run by VET Hospitality students with help from their dedicated teachers. The school is close to all other sporting facilities in the town, including the Shire Swimming Pool, and enjoys close co-operation and assistance from all sporting bodies. Students from Rutherglen High School have an outstanding record in interschool

sports competitions.

School Council is committed to continually upgrading the buildings and grounds. A particular emphasis is placed on upgrading resources to keep students abreast with changing technology. Teacher Professional Leave teams advocated the development of 'flexible learning spaces'. Teams of teachers work collaboratively in these spaces and develop teaching programs to be implemented by using innovative and engaging teaching and learning practices. More recently, there has been research undertaken on increasing extending and challenging students and this has resulted in the implementation of a 'Master Class'. The School was involved in the Federal Government's Trade Training Centre Program which included a new state of the art Woodwork and Metalwork area, and a new extended Art area. In 2018, the new Science, Technology Engineering and Maths (STEM) Centre was completed using a state government grant of \$1.6 million.

The School atmosphere is supportive, caring and friendly. There is an effective wellbeing and student management policy in place, supported by Sub School Leaders, Year Level Coordinators, and a Student Wellbeing Coordinator. The school also has a School Nurse two days per week, a Mental Health Practitioner three days a week and a doctor on site for half a day per week under the Doctors In Schools initiative. A Careers Advisor is available to help students make appropriate choices in school and beyond.

School Captains, House Captains and the Student Representative Council foster student participation and responsibility. Parental involvement is welcomed and high value is placed on the home/school partnership. The school also encourages and enjoys strong links with the community. Rutherglen High School is a great place to be affiliated with, whether it be as a student, teacher or general community member. Working together will see Rutherglen High School have a very bright and exciting future.

Rutherglen High School Captains 2024



From left to right: Lavinia Fisher (Vice Captain); Thomas Frazier, Kayla Horne (Captain); Lily Wells (Vice Captain)

Who's Who?? Staff at Rutherglen High School

Principal	Cassandra Walters
Assistant Principal	Nicole Jasinowicz
Business Manager	Julie Jones
Year 7 Coordinators	Darby Griffin
Year 8 Coordinators	Krys Evgenidis
Year 9 Coordinators	Sam Wickham/ Mick Dow
Year 10 Coordinators	Joanne Lynn & Rebecca Kennett
VCE Coordinator	Brooke Rasmussen
Literacy Leader	Jade Lappin
Numeracy Leader	Jenna McFarlane
Humanities Leader	Sarah Cohen
Science Leader	Sean Arbutnot
Art-Technology Leader	Di Kotzur
Sport Coordinator	Jane Baring
Music Coordinator	Peter Scott
Student ICT Support	De McDonald
Leading Teacher: Junior School	Ronald Webb
Leading Teacher: Senior School	Ronald Webb
Leading Teacher: Curriculum	Sarah Elphick
Leading Teacher: Wellbeing & Inclusion	Amanda Steer
Leading Teacher: Literacy	Jade Lappin
Leading Teacher: Numeracy	Jenna McFarlane
Careers Coordinator	Lou Webb
SEPL Coordinator	Cassandra Walters
School Doctor	Dr Buddhi
School Nurse	Shannon Treacy
Mental Health Practitioner and Koorie Inclusion	Miranda Schroeder
ICT Technician	Will O'Connell
Canteen Manager	Lynne Kerr

Location of Rutherglen High School

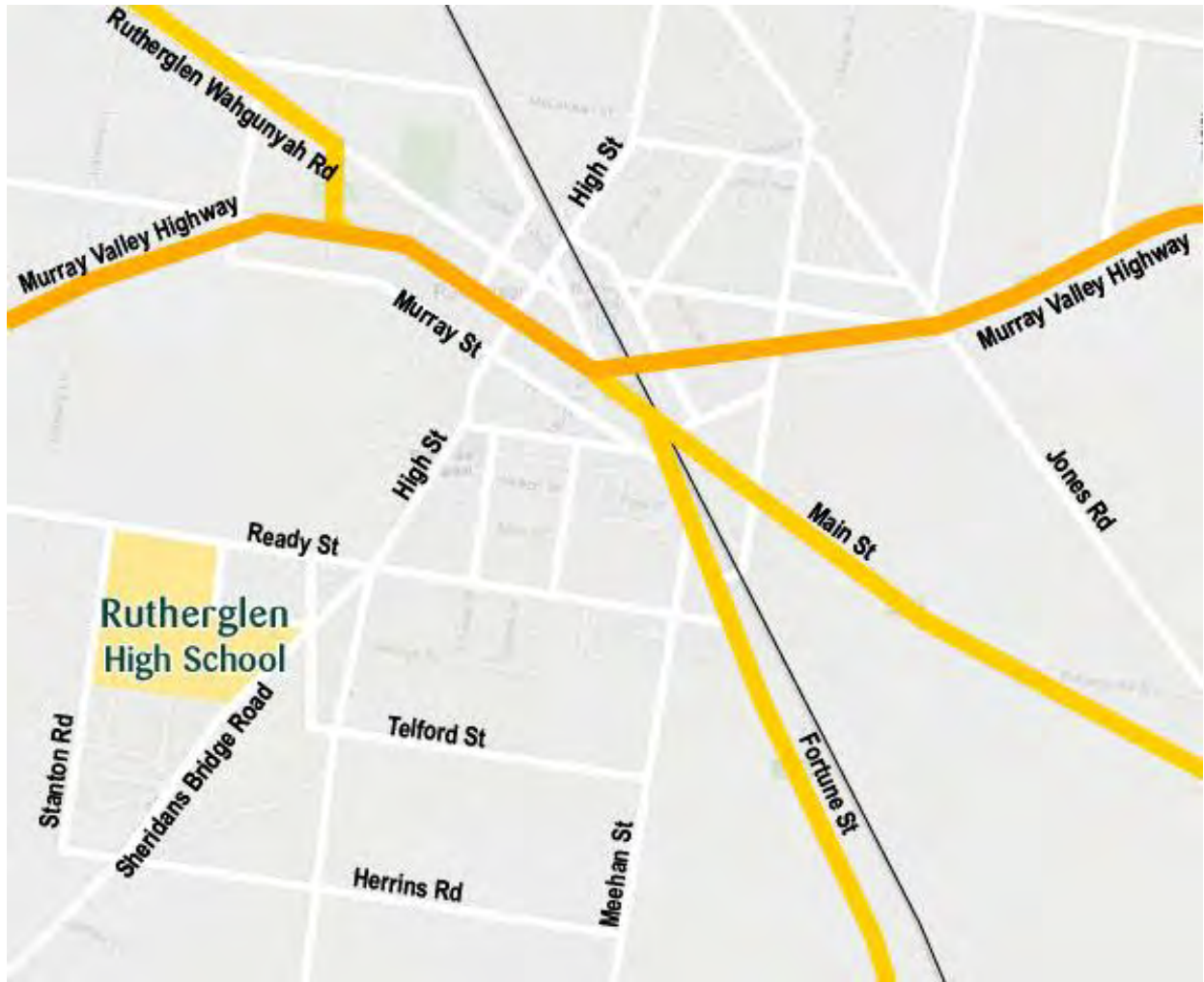

Rutherglen High School

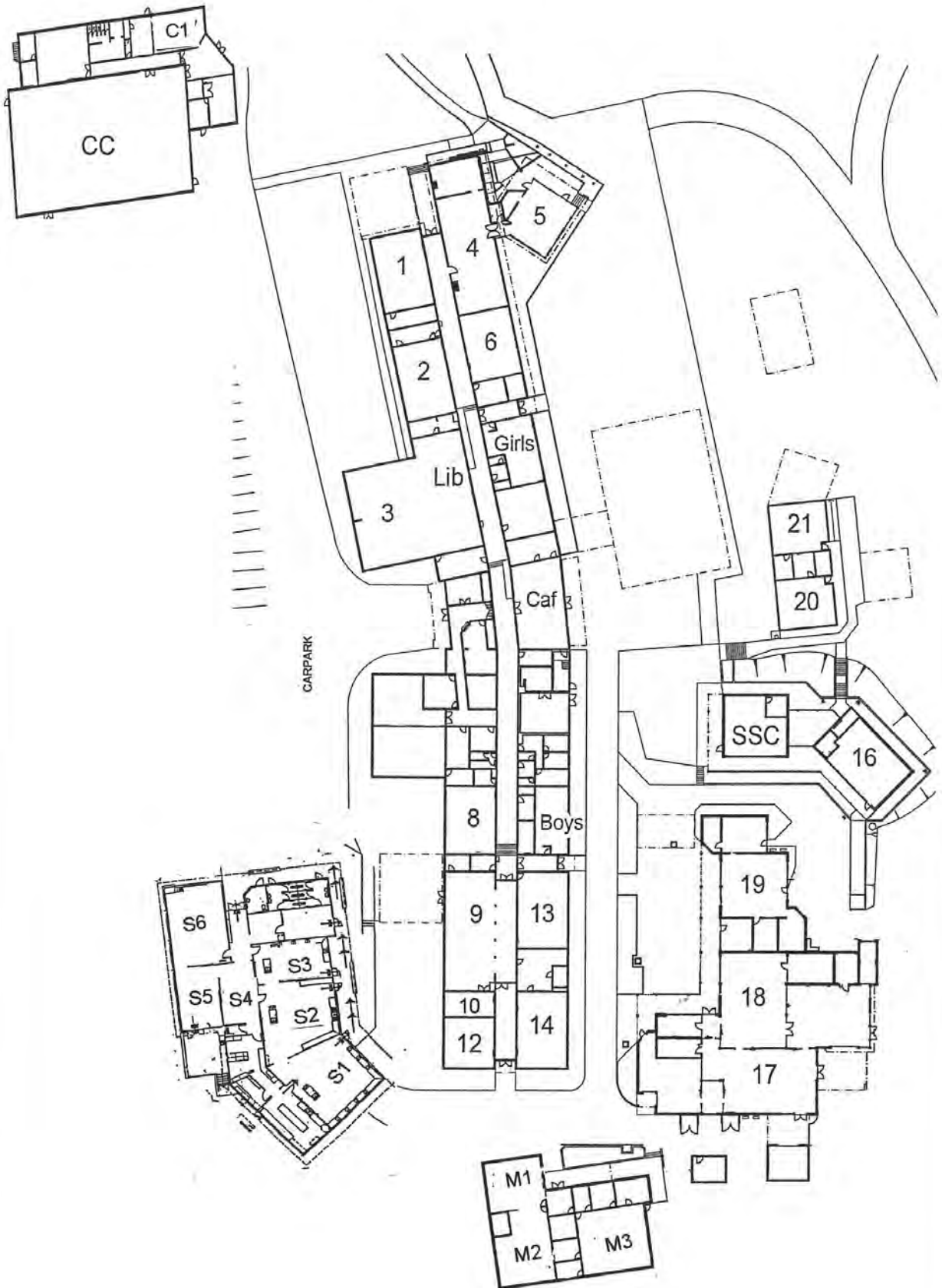

Daily Organisation

HOURS

- 8.50 am - 3.20 pm, Monday to Friday.
- **Students should aim to arrive at school between 8.40 am and 8.50 am.**
- **NOTE: Students should not arrive at school before 8.30 am.**

BELL TIMES

BELL	MONDAY (Year Level Assembly Day)	TUES/WED/THUR/FRI
WARNING Students collect books for P1 and P2	8.50 AM	8.50 AM
PERIOD 1	9.13	8.55
PERIOD 2	9.59	9.45
RECESS	10.47	10.35
WARNING Students collect books for P3 and P4	11.07	10.55
PERIOD 3	11.12	11.00
PERIOD 4	11.59	11.50
LUNCH	12.47 PM	12.40 PM
WARNING Students collect books for P5 and P6	1.41	1.35
PERIOD 5	1.46	1.40
PERIOD 6	2.33	2.30
DISMISS	3.20	3.20

Note: Bell times for Year Level Assembly days vary depending on when the assembly is held.

DAILY BULLETIN

A Daily Bulletin is put up on the notice boards before school each morning and is also on the **school website**. Students must read the Daily Bulletin each morning. The Bulletin contains items of information concerning special events, assemblies, changes of schedule and duty rosters. Teachers and students may contribute news items.

Transition Program

Our Transition program focuses on building students' social circles so that they feel confident and supported when they enter Secondary School. The various transition days, activities, information sessions and social events that are built into the program encourage students to form connections with students and teachers beyond their Primary School. It is a great opportunity to meet with other students and their new teachers at Rutherglen High School. A number of Transition Orientation days occur throughout the year for Grade 5 and Grade 6 students from all feeder Primary Schools, however the proposed **official state-wide Orientation Days held in December 2025 are yet to be announced.**

The theme continues at the beginning of Year 7 with an introductory program which includes a 3-day camp at Howman's Gap. This focuses on consolidating the skills and knowledge students need to feel comfortable in their transition from Primary School to Secondary School. This camp is a valuable educational experience and we strongly encourage all students to participate. We endeavour to keep costs to a minimum and we support parents in any way we can. The camp takes place in the early weeks of Term One. During this time students, teachers and instructors participate in a range of outdoor activities. Some of these include rock climbing, bush walking, orienteering, canoeing, obstacle courses and high ropes activities. The feedback each year is invariably positive and we believe that the experience plays an important role in building the students' connection with our School.



Subjects Offered at Year 7

Core subjects for all Year 7 include the following:

Subject	Periods
Communicate – a combination of English and Humanities	8 periods
Mathematics	5 periods
Science including Health Education	4 periods
French	3 periods
Elective Rotation	3 periods
Elective Rotation	3 periods
Physical Education	2 periods
Sport – an elective rotation of different sports are offered	2 periods

A rotation of the following electives are offered over Years 7 & 8. Each of these run for one semester (3 periods in length) and all students complete eight of these subjects in the rotation over the course of two years.

Woodwork	Metal Work
Performance	Music
Art	Visual Communication and Design
Food Technology	Textiles

Year 7 at Rutherglen High School

Rutherglen High School believes that one of the greatest priorities in the early years of secondary schooling is for students to establish themselves comfortably and confidently within the School community. We understand that for students and parents, the transition to Secondary School can be an exciting, yet daunting experience. We see it as our responsibility to support students and their families throughout their entire time at Rutherglen High School and to ensure all students are provided with everything they require in order to achieve to the best of their ability. Rutherglen High School commits itself to shaping students who will go on to become lifelong learners; therefore we provide a multicultural curriculum which encourages students to develop academically, personally, socially and physically.

Throughout the years, teachers have been awarded professional leave to focus on a range of different teaching aspects. A particular focus has been on team teaching, new and innovative curriculum, and student engagement. Rutherglen High School recognises that students today are very different to students from earlier generations. They learn, think and communicate in ways that are far more complex than students who have gone before them. With this knowledge, teachers and School must reflect upon their own skills and knowledge. The ongoing professional learning is an inherent part of our teaching, particularly in Year 7. Ongoing research is a feature of our teaching practice, helping us to continue to cater for the needs of all students.

The Year 7 program has been designed to complement the already successful Year 9 program by supporting students to develop essential skills such as communication, reflection, cooperation and resilience. The program allows students the opportunity to determine the direction of their learning and to take responsibility for their own learning. The approach involves the integration of traditional key learning areas (such as English and Humanities) to form larger areas of study that encourage students to see the link within their own learning. Students are taught in a variety of methods, ranging from individual study, to small group collaboration. Most of the learning takes place in a flexible learning space that offers the teachers and students more variety in the way the curriculum is delivered and explored.

Literacy and Numeracy development are two key focus areas within Rutherglen High School and this is reflected in the provision of additional class support for all students in Year 7. In future, there will be a continued awareness of the need to differentiate in the classroom to ensure that all students are being catered for, including the gifted and talented students. Other than the traditional core subjects, all Year 7 students also study French. Further to this, we also offer a diverse instrumental music program where students can engage in one on one music lessons involving the instrument of their choice. Rutherglen High School has a well-supported and resourced sports program that provides students with the opportunity to compete at local, interschool and state level.

We pride ourselves on the range of opportunities we provide for our students to involve themselves in the local community and beyond. We are constantly seeking and developing new ways to expand our already impressive list of extra-curricular activities. Throughout their time at Rutherglen High School, students are provided with various leadership opportunities. These include Student Representative Council (SRC), House Captaincy, Sports Captaincy, and Student Council Presidency. We value input from students and believe in the importance of students building their skills to make decisions and communicate effectively. We support our students in other leadership opportunities through involvement in debating, public speaking and extended leadership opportunities such as Future Makers, School for Student Leadership and the . A number of Rutherglen High School students have also been successful in gaining places in the Victorian Young leaders to China program. This is an outstanding opportunity and all participants relished this once in a lifetime opportunity.

We ensure that our Year 7 students feel welcome, safe, confident and comfortable at Rutherglen High School and that they understand the level of support that is available to them as well as appreciate the experiences that they will have throughout the rest of their schooling. Rutherglen High School prides itself on providing every student with the best opportunities possible in relation to their individual learning, leadership opportunities, extra-curricular activities and career pathways.



RUTHERGLEN HIGH SCHOOL CODE OF COOPERATION

Is it fair?

Is it safe?

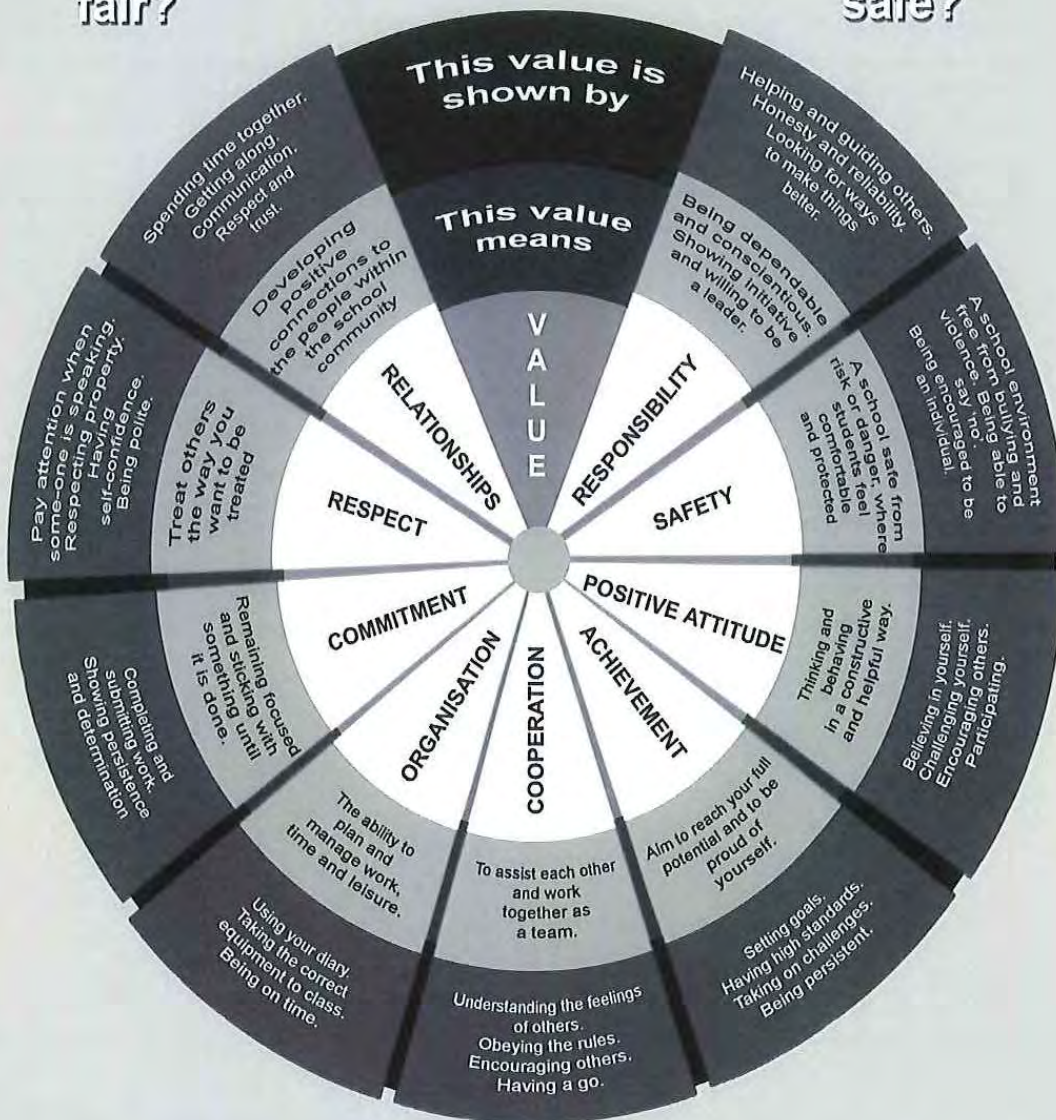

Is it the right choice?



Does it make the school a better place?

Rutherglen High School

Rules that flow from our Code of Cooperation

THE RELATIONSHIPS RULES	School Community members will get to know each other. Interaction and communication will be based on respect and trust.
THE RESPECT RULES	School Community members will respect each other's differences. They will respect themselves, each other and property.
THE COOPERATION RULES	School Community members will show consideration for the feelings of others. They will strive to become effective team members.
THE RESPONSIBILITY RULES	School Community members will be honest, reliable and work productively together to achieve successful outcomes. They will accept responsibility for their own actions and the consequences that follow.
THE SAFETY RULES	School Community members will create a safe and supportive environment. Bullying or violence will not be tolerated.
THE POSITIVE ATTITUDE RULES	School Community members will challenge themselves and encourage others to participate in activities. They will have pride in themselves and their school.
THE COMMITMENT RULES	School Community members will show persistence and determination in working towards a goal. Students will complete and submit all work as required.
THE ORGANISATION RULES	School Community members will be prepared and organised. Students will use their diaries, take the correct equipment to every class or activity and will be punctual.
THE ACHIEVEMENT RULES	School Community members will set challenging and achievable goals. Students will have high standards and will be persistent in their learning.

CHILD SAFE STANDARD 2:

STATEMENT OF COMMITMENT TO CHILD SAFETY

Rutherglen High School is committed to safety and wellbeing of all children and young people. This will be the primary focus of our care and decision-making.

Rutherglen High School has zero tolerance for child abuse.

Rutherglen High School is committed to providing a child safe environment where children and young people are safe and feel safe, and their voices are heard about decisions that affect their lives. Particular attention will be paid to the cultural safety of Aboriginal children and children from culturally and/or linguistically diverse backgrounds, as well as the safety of children with a disability.

Every person involved in Rutherglen High School has a responsibility to understand the important and specific role he/she plays individually and collectively to ensure that the wellbeing and safety of all children and young people is at the forefront of all they do and every decision they make.

Staff are mandated to report on the basis of reasonable belief. They are subject to legislation regarding failure to protect and failure to disclose if they do not act in accordance with these requirements.

This Statement of Commitment describes the school's principles for child safety.

In its planning, decision-making and operations Rutherglen High School will:

1. Take a preventative, proactive and participatory approach to child safety;
2. Value and empower children to participate in decisions which affect their lives;
3. Foster a culture of openness that supports all persons to safely disclose risks of harm to children
4. Respect diversity in cultures and child rearing practices while keeping child safety paramount;
5. Provide written guidance on appropriate conduct and behaviour towards children;
6. Engage only the most suitable people to work with children and have high quality staff and volunteer supervision and professional development;
7. Ensure children know who to talk with if they are worried or are feeling unsafe, and that they are comfortable and encouraged to raise such issues;
8. Report suspected abuse, neglect or mistreatment promptly to the appropriate authorities;
9. Share information appropriately and lawfully with other organisations where the safety and wellbeing of children is at risk; and
10. Value the input of and communicate regularly with families and carers.

WHAT YOU SHOULD DO . . .

if

YOU ARE OUT OF UNIFORM

You must present a note from your parents and your diary to your Year Level Coordinator. If the Year Level Coordinator is not available you should present the note and your diary to your Sub School Leader

YOU ARE LATE

You should report to the General Office to be given a late pass to take to your class teacher

YOU REGULARLY GO HOME FOR LUNCH

You should collect a form from the Assistant Principal, have this completed by a parent and return the form to the Assistant Principal. A lunch pass permits students to go directly home and back to school. **It is not permission to go to the shops.**

YOU ARE ABSENT

- Rutherglen High School has a 24 hour absence line with an answering machine. **The absence line number is (02) 60 329 818.**
- When your parents know that you will be absent from school, they should ring and:
 1. Identify themselves as your parent/guardian
 2. State your name and form
 3. State the reason for the absence and the expected length of the absence. (A follow-up note may be required.)

YOU HAVE PRIVATE STUDY

- Students must sign the private study roll at the General office at the start of each private study session. VCE students refer to Senior School Policy.

YOU MISS WORK DUE TO AN ABSENCE, APPOINTMENT OR INVOLVEMENT IN ANOTHER SCHOOL RELATED ACTIVITY

- You are responsible for any missed work and must seek information from your teachers concerning catch-up requirements.

YOU HAVE LOST PROPERTY

If you lose personal property ask a teacher if you can check inside the blue lost property cupboard in the bottom staffroom. **ALL OF YOUR POSSESSIONS SHOULD BE LABELLED**

YOU FEEL UNWELL DURING THE DAY

If you feel unwell you should report to the Staff in the General Office. Do not go into the sickbay unless you have permission to do so.

YOU BRING VALUABLES TO SCHOOL

Large sums of money, mobile phones, etc should not be brought to school. If valuable items must be brought to school they must be left in the General Office for safekeeping before school and collected at the end of the day.

YOU WISH TO ORDER LUNCH

Orders should be placed in the Cafeteria before 8.50am

PERSONAL SAFETY AND WELFARE ISSUES

AMBULANCE SUBSCRIPTION

The School is not able to cover the cost of transport by Ambulance of a student who requires emergency hospital treatment. If an Ambulance is used in an emergency, the cost will be to the parent.

- **TO AVOID THIS POSSIBILITY ALL PARENTS ARE URGED TO TAKE OUT A SUBSCRIPTION TO THE AMBULANCE SERVICE.**

INSURANCE

Parents should recognize that accidents which cause injury to students happen from time to time. School Council is not responsible for medical cost incurred as a result of accidents which happen during school hours.

Parents are urged to take out Personal Accident insurance to cover their child. Details will be made available in a 'Newsletter' early in the new year.

Mouth Guards

Students are strongly encouraged to wear mouth guards when they are participating in sports which might involve physical contact. The potential consequence of not using mouth guards is obvious.

Aerosol / Spray Deodorant

Aerosol deodorants are not to be discharged inside. If not used appropriately, they will be confiscated. Roll on deodorants can still be used.

Personal Details

Parents/guardians are expected to notify the school immediately of any change of personal details including contact phone numbers for work and home and emergency contacts, also medical details of students, custody orders etc.



BULLYING OR HARASSMENT.....

Are not on at Rutherglen High School

Rutherglen High School is committed to providing an environment free from bullying or harassment. Every individual has the right to attend school feeling safe and comfortable. Bullying and Harassment make the victim feel powerless and affects their morale, confidence and health. Bullying and Harassment mocks the values that our community believes to be most important. Bullying and Harassment will not be tolerated under any circumstances. Such behaviour has no place in a community which promotes respect for the individual

Definition of Bullying

Bullying is when someone, or a group of people, upset or create a risk to another person's health and safety - either psychologically or physically - or their property, reputation or social acceptance on more than one occasion.

Types of Bullying

There are three broad categories of bullying.

- Direct physical bullying e.g. hitting, tripping, and pushing or damaging their property.
- Direct verbal bullying e.g. name calling, insults, homophobic or racist remarks, verbal abuse.
- Indirect bullying - This form of bullying is harder to recognise and often carried out behind the bullied student's back. It is designed to harm someone's social reputation and/or cause humiliation. Indirect bullying includes:
 - o lying and spreading rumours
 - o playing nasty jokes to embarrass and humiliate
 - o mimicking
 - o encouraging others to socially exclude someone
 - o damaging someone's social reputation and social
 - o acceptance
 - o cyber-bullying

What is Cyber Bullying?

Cyber Bullying is Bullying that is carried out through an internet service, such as email, chat room, discussion group or instant messaging. It can also include bullying through mobile phone technologies such as short messaging service (SMS).

Examples of cyber bullying include teasing, spreading rumours online, sending unwanted messages, or defamation. Cyber bullying causes humiliation and distress

Cyber Bullying - A Criminal Offence

If somebody uses technology in an inappropriate fashion then they could be committing a crime. Messages, phone calls, and chat rooms can be traced, even if a false name is used.

Mobile Phones

Are **not** to be brought to school. Phones required for after school use should be placed in the General Office before school and collect after school. Phones confiscated must be collected by a parent/guardian.

WHAT TO DO IF YOU HAVE A HARASSMENT PROBLEM

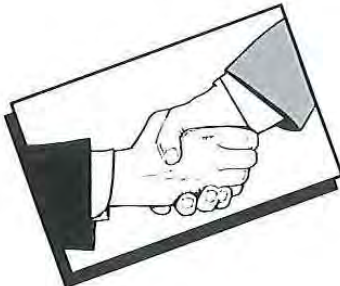
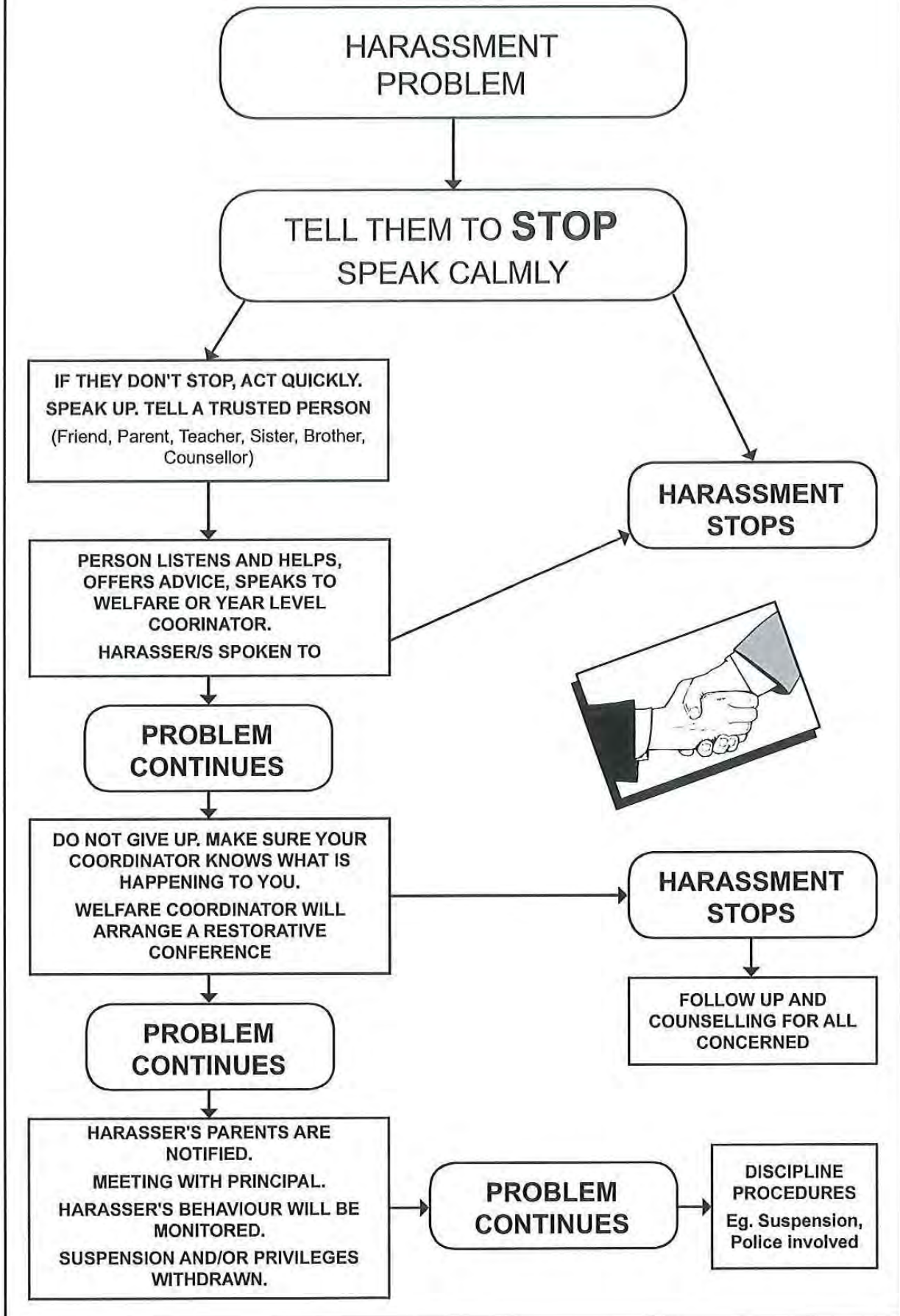

School Dress Code

Rutherglen High School Council believes that uniform provides a neat, economical and functional dress for students. Council believes that uniform has a positive role to play in promoting a sense of individual and collective pride in students and their identification with the School. School uniform also has the potential to promote group security both in and out of school situations. It enhances the safety of individual students.

The School Council Dress Code takes precedence over a students' individual preference in matters of dress. It is expected that all students will be attired in the correct school uniform for normal classes, Physical Education and Sport.

UNIFORM SUPPLIER

- Brunella Schoolwear: 160 Sanger Street Corowa. Telephone: 6033 0233

GIRLS UNIFORM - SUMMER

a) **Dress:** Available from uniform suppliers.

OR

b) **Bottle green shorts:** Tailored polyester/gabardine shorts with 2 side pockets, zip front and two pleats at the waist - either side of the centre front. Shorts are to be above knee length. Bottle green is the only permitted colour.

c) **Shirt:** Plain white shirt or polo shirt with short or long sleeves and COLLAR with school emblem. There are to be no insignias, motifs or slogans anywhere on the shirt and NO coloured under shirts.

d) **School jumper or School windcheater:** Bottle green jumper with school emblem OR bottle green windcheater with school emblem.

e) **Shoes: Black shoes or runners only** worn with plain white, black or grey socks

- Must be of sturdy construction providing support and protection
- Toes/foot area must be enclosed or covered
- If there are laces, they must be black and tied
- Insignias, stripes, logos etc are not acceptable
- Soft, flimsy ballet style shoes or slip-ons are **NOT** acceptable.

f) **Hats:** Broad brimmed or bucket style hats are encouraged for Sport & PE classes, at recess and lunch times and during other outdoor activities in Terms 1 & 4. Baseball style caps are not permitted.

GIRLS UNIFORM - WINTER

a) **Skirt:** Pleated style tartan skirt this is the only style to be bought. The length of this skirt must be to the knee.

b) **Bottle green trousers:** Bottle Green is the only permitted colour. No jeans, tracksuits, cords, cargos or tartans are permitted.

c) **School jumper or School windcheater:** Bottle green jumper with school emblem OR bottle green windcheater with school emblem.

d) **Shirt:** Plain white shirt or polo shirt with short or long sleeves and COLLAR with school emblem. There are to be no insignias, motifs or slogans anywhere on the shirt and NO coloured under shirts.

e) **Shoes:** Black shoes or runners only worn with plain white, black or grey socks, or black stockings

- Must be of sturdy construction providing support and protection
- Toes/foot area must be enclosed or covered
- If there are laces, they must be black and tied
- Insignias, stripes, logos etc are not acceptable
- Soft, flimsy soled shoes or slip-on shoes are not acceptable.

BOYS UNIFORM - SUMMER

- a) **Shirt:** White polo shirt with short or long sleeves and COLLAR with school emblem. There are to be no insignias, motifs or slogans anywhere on the shirt and NO coloured under shirts.
- b) **Shorts/trousers:** Mid Grey shorts (above knee length) or mid grey trousers. (No logos or insignias on either). No cargo shorts / trousers.
- c) **Shoes:** Black shoes or runners only worn with plain white, black or grey socks
- Must be of sturdy construction providing support and protection
 - Toes/foot area must be enclosed or covered
 - If there are laces, they must be black and tied
 - Insignias, stripes, logos etc are not acceptable
 - Soft, flimsy ballet style shoes or slip on shoes are not acceptable.
- d) **School jumper or school windcheater:** Bottle green jumper with school emblem OR bottle green windcheater with school emblem.
- e) **Hats:** Broad brimmed or bucket style hats are encouraged for Sport & PE classes, at recess and lunch times and during other outdoor activities in Terms 1 & 4. Baseball style caps are not permitted.

BOYS UNIFORM - WINTER

- a) **Grey trousers:** Colour mid grey. No cargo trousers or tracksuit pants.
- b) **Shirt:** White shirt or polo shirt with short or long sleeves and COLLAR with school emblem. There are to be no insignias, motifs or slogans anywhere on the shirt and NO coloured under shirts.
- c) **School jumper or school windcheater** Bottle green jumper with school emblem OR bottle green windcheater with school emblem.
- d) **Shoes: Black shoes or runners only** worn with plain white, black or grey socks
- Must be of sturdy construction providing support and protection
 - Toes/foot area must be enclosed or covered
 - If there are laces, they must be black and tied
 - Insignias, stripes, logos etc are not acceptable
- Soft flimsy soled shoes or slip-on shoes are not acceptable.

VCE UNIFORM

Jumper: Navy blue jumper with VCE School logo is available. Otherwise the normal green school jumper or school windcheater must be worn.

Note: A white polo shirt with VCE school logo for VCE summer uniform is available.

Dresses/Shorts/Skirts/Trousers, Shoes and socks: As per Years 7 - 10.

Rugby Top: Rugby tops are permissible under the following conditions:

- Restricted to Year 12 students only
- Restricted to school colours blue and green and the house colours
- School logo must **appear**
- It is optional to have the Year appear on the top.
- Correct names to be used — no inappropriate nick names
- Apart from the optional year there are no other numbers appearing on the top
- The final decision is to be approved by the Principal and ratified by School Council.
- The VCE navy blue jumper is required for official school occasions.

OPTIONAL JACKET

A water resistant jacket in school colours is an optional item for cold weather.

Note: The jacket may be worn in class and does not replace the school jumper or windcheater. Students are expected to have a school jumper or windcheater.

Uniform options at Rutherglen High School



PHYSICAL & SPORT EDUCATION (Compulsory for all students)

This school Physical and Sport Education uniform is still applicable on a school casual clothes day.

- a) **Shorts:** Black above the knee shorts (no logos or insignias).
- b) **Wrap-around skirt:** Girls - black or green wrap-around skirt, or black bicycle shorts or black above the knee shorts.
- c) **Shoes:** Appropriate sporting footwear - Not normal School Shoes!
Socks: white only.
- d) **Shirt:** Green polo shirt with school emblem.
- e) **Mouthguard:** Recommended

OPTIONAL

- a) **Polo shirt/t-shirt:** Coloured house polo shirt with school emblem.
- b) **Coloured House rugby top:** With school emblem.
- c) **Black tracksuit pants:** For winter activities.
- d) **Hats:** Broad brimmed or bucket style hats are encouraged for Sport & PE classes in Terms 1 & 4. Baseball style caps are not permitted.

NOT ACCEPTABLE

Patterned, striped or multi-coloured shorts, skirts, shirts, windcheaters, singlet tops and thongs.

JEWELLERY

The wearing of valuable jewellery, other than watches, to school is discouraged for security reasons.

- Rings - single, plain band only. Multiple rings or protruding rings are not permitted.
- Chains/necklaces - must be worn concealed.
- Earring/Ear studs - Plain rings or studs. Elaborate or pendant earrings not permitted.
- Facial Piercings - Plain stud only.

Note: During certain classes or activities, eg sport, physical education or practical classes, students may be asked to remove jewellery for safety reasons.

UNIFORM SUPPLIER

Brunella Schoolwear: 160 Sanger Street
Corowa NSW
(02) 60 330 233



General Information

Student Diary

The student diary is an essential learning tool that allows students to organise their time and commitments whilst also providing a great deal of valuable information, learning goals and learning tools. Year 7 students are provided with a diary at the beginning of the year. They are expected to always use it and maintain it in a responsible manner. Parents are encouraged to regularly check the student diary and monitor homework.

Reports and Interviews

Full reports are issued in Semester 1 and Semester 2. Interim Reports are issued at the conclusion of Term 1 and Term 3. **All reports are available to Parents/Guardians via COMPASS.** Two formal parent/teacher/student interviews are organised: The first at the end of Term 1 and the second during Term 3. All parents and students are expected to attend these interviews. **Interviews are to be booked via COMPASS.**

Booklists and fees

Booklists will be distributed to all students in early November. These need to be completed online. If purchasing second hand items or items from another distributor, please ensure that texts comply with the correct edition on the list.

School Canteen/Cafeteria - *'THE CAF'*

Rutherglen High School has its own canteen known as The Caf.

The Caf provides students with affordable, healthy, appetising meal options. The Caf is open at recess and lunch time, and lunch orders can be made by all students.

The Caf's menu is published in school newsletters and on the school website.



In addition to the healthy and tasty menu available from The Caf, students can also bring food from home.

In The Caf area there are microwaves and sandwich toasters, and a wall urn providing hot water for noodles, soups etc.

Students can even store their food in a fridge to keep it fresh and healthy!

Wellbeing

The school is divided into two sub-schools – a Junior School (Years 7, 8) and a Senior School (Years 9, 10, 11 and 12). Each of these sub-schools has a Leading Teacher allocated to it and each year level also has one or two coordinators. The appropriate Leading Teachers and Year Level Coordinators are specifically responsible for the wellbeing of students. The School also has a Wellbeing Coordinator who has an overall responsibility for the support of students and their families and the School has access to a number of outside agencies to further assist. These may include counsellors, psychologists, and Community Health agencies.

Rutherglen High School's Wellbeing Team incorporates the position of the Adolescent Health Nurse as well as Year Level Coordinators, the Wellbeing Coordinator and Sub-School Leaders. Our Wellbeing Team works hard to support students in their transition years and beyond. The Nurse promotes student wellbeing with preventative programs and initiatives. In Year 7 and 8 the Adolescent Health Nurse runs a series of one term programs called 'Friendship Groups'. These programs aim to discuss various health and development related issues as well as providing opportunities to work on team and social skills. They also aim to support the students' transition to Rutherglen High School and promote wellbeing and resilience, while also preventing bullying. The program focuses on different topics each week. Some of these include:

- Self-esteem, anti-bullying and resilience
- Body image
- Respectful relationships and personal development
- Healthy lifestyle choices (eating, physical activity and mental health)

Friendship Groups are conducted in a small group environment. The sessions are a unique opportunity for Year 7's to discuss issues in a comfortable environment and with a member of the Wellbeing Team. Students generally attend one session per week over a 5-week period. The Adolescent Health Nurse may also attend local Primary Schools to support teaching staff with the delivery of the program "Puberty and Personal Development" for Grade 5 and Grade 6 students. This assists with the transition into Secondary School and begins the relationship with the Wellbeing Team from Rutherglen High School.

DOCTORS IN SECONDARY SCHOOLS PROGRAM

Rutherglen High School is part of the Victorian Government's Doctors in Secondary School Program. As part of this program, Dr Sally Smith, an adolescent-trained General Practitioner (GP) from the Corowa/Rutherglen Medical Clinic, will be operating on the school grounds **fortnightly on Wednesdays** to provide free access to primary health care for students at our school. More information on consent, confidentiality and medical treatment by a GP is included in the information sheet, which is on the Doctors in Secondary Schools webpage at:

http://www.asc.vic.edu.au/documents/newsletters/doctors_secondary_schools_parent_info.pdf

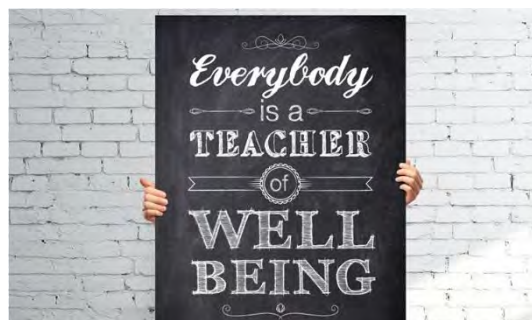

Extra-curricular Activities

Some of the many Junior School Extra-curricular activities on offer

- * Year 7 Orientation Camp (Howman's Gap)
- * Year 8 Mount Buffalo Fieldwork (Mt Buffalo)

Some of the many Senior School Extra-curricular activities on offer

- * Year 9 Future Makers Camp (Bogong)
- * Year 10 Urban Experience Camp (Melbourne)
- * Year 10 Mock Interviews
- * Year 11 and 12 University Trips
- * Year 12 Study Skills Camp
- * International Women's Day breakfast, hosted by Zonta International (Wangaratta)

Some of the many sporting Extra-curricular activities on offer

- * RHS Swimming Carnival (Local Pool)
- * RHS Athletics Carnival (Alexandra Park)
- * Various Inter-School Sports
- * Hume Lawn Bowls
- * O&M Swimming, Cross Country, Lawn Bowls
- * Rowing Regatta (Geelong)
- * Super 8's Cricket (Baranduda Park)
- * Cross Country
- * The Great Victorian Bike Ride

Some of the many extension/Leadership opportunities on offer

- * School for Student Leadership
- * National Youth Science Forum
- * Rotary Public Speaking
- * John Monash Science School
- * Young Women Leadership Academy
- * Rotary Youth Program of Enrichment (RYPEN)

What's GREAT about Rutherglen High School

Year 7 and 8 curriculum – Integration and innovation in core subjects. A semester of all eight electives in order to make informed choices later in school.

Year 9 program – Choice of electives as well as a large community based curriculum. This program provides students with an effective transition from Junior School to Senior School.

Year 10 options – Choice of electives as well as the choice between traditional subjects and 'Applied Learning'. Also the opportunity to engage in Work Experience.

Year 11 and 12 options – VCE scored, VCE non-scored, VCAL and VET. Regardless of student's pathway, the School has many options to cater for all.

A broad range of VCE subjects – Students pathways are a high priority at Rutherglen High School, therefore we offer a large range of VCE subjects in order to attempt to cater for all.

Industrial kitchen facilities – New and modern cooking facilities for Junior Food Technology students and Senior VET Hospitality students.

'The Vine' restaurant – VET Hospitality students put their skills to practice with regular restaurant 'open nights' where members of the public can enjoy a fine meal.

Art/Technology area – Fitted with brand new, high quality woodwork benches, industrial machinery and Apple Mac Computers. An innovative space for junior students as well as VET engineering students.

Technology – Years 7 - 12 students have access to their own netbooks. There are also two Computer Labs and a number of desktops in the library which students can use. Apple Macs are used in the Music room and Art rooms.

Library – Open before & after school, and every lunch time. Not only a place for reading and borrowing books (including eBooks!), but also a place to use computers in order to finish off class work or homework, and a safe & comfortable space to sit and chat or simply sit and 'chill'. Staff are 'on deck' all day, every day to assist with classroom work.

The STEM Centre – The school has a brand new Science Technology Engineering Maths (STEM) Centre completed in 2018 using state government funding of \$1.6 million.

Community Centre – Indoor sports and gym facility, used for Sport and Health and Physical Education classes as well as by students at lunch time. The community also use this facility for local sporting competitions.

The Farm – Engaging students in industry specific learning and hands on skills. The School boasts a successful Year 9 'Farm' elective as well as VCE Agriculture and Horticulture.

The Music Centre – Junior music classes as well as individual or small group instrumental music lessons. Complete with a vast range of impressive musical instruments, this is a great area to rehearse for the School Production and/or Variety Night.

Senior Study Centre – Senior students have access to their own VCE Centre where they undertake supervised study periods. The Senior School Leader is also situated in the VCE Centre for any assistance that may be needed.

Rutherglen High School is a very safe, happy, welcoming and caring school.

What else is GREAT about Rutherglen High School?

- The School is situated on 30 acres of land;
- We have competent, caring and capable Office Administration staff;
- We have dedicated and supportive teaching staff;
- The small school enables teachers to know their students well;
- We offer various extra-curricular activities each year;
- The School has a fantastic Sport and P.E. Program;
- Our class sizes are smaller than many other schools;
- Year 7 students have a designated area for recess and lunch time;
- The Library is open before school, after school and every lunch time for students to access resources and staff support;
- An impressive Rutherglen High Careers page helping students make decisions about their future;
- A number of past and current teachers were once students at this school;
- Rutherglen High School is a safe and happy place for all.

Positive affirmations from past students of Rutherglen High School students:

'I moved to Rutherglen High School at the beginning of Year 9 where I developed personal relationships with staff and received personalised academic support from small class sizes that guided my education. Along with individual academic support, Rutherglen provided me with endless opportunities to grow as a person; including Mittagundi Leadership camp and Cattle handling program that improved my leadership skills and animal handling experience. The opportunities and educational support at Rutherglen High School prepared me for my transition to Veterinary Science at University'

Tayla Price

'I completed all my high school education through Rutherglen High School. The six years that I spent in the school's supportive environment allowed me to grow and acquire the necessary skills and knowledge that have allowed me to get into my ideal course at university. The personal relationships developed and opportunities (Year 10 Melbourne Trip, Cattle Handling) provided by the school has prepared me for life beyond high school'.

Sarah White

- www.rutherglenhs.vic.edu.au
- 40 Sheridan's Bridge Road - Rutherglen - Victoria - 3685
- 02 60 329 483 rutherglen.hs@education.vic.gov.au

